

PREMIA ES

PEDESTRIAN POWER PALLET TRUCK

PBP16-20N2(R)(E) Series 1.6-2.0 TON

*Ready to Perform
To Your Applications*



PBP20N2E



PBP20N2R

www.mitforklift.com.sg

© 2019 by MLAP. All Rights Reserved. All registered trademarks are the property of their respective owners. Printed in Singapore.

FMIT0157(01/19)

PRESENTED BY :



Note: Performance specifications may vary depending on standard manufacturing tolerances, vehicle condition, types of tyres, floor or surface conditions, applications or operating environment. Trucks may be shown with non-standard options. Specific performance requirements and locally available configurations should be discussed with your Mitsubishi forklift truck dealers. Mitsubishi Forklift Trucks follows a policy of continual product improvement. For this reason, some materials, options and specifications could change without notice.

Exceptional

Performance



PBP20N2E

High stability and a market-leading lift height allows easy operation on uneven surfaces. Outdoor operation is possible in all weather, thanks to protection of the chassis and electrical systems against rain and splashing water. Low maintenance design, with no vulnerable components, minimises the chance of breakdown and lowers servicing costs.

For extra versatility, operators may choose between two performance modes via the key switch. In all models the state-of-the-art, simple-to-use tiller arm design protects hands and places everything within easy reach for safe, comfortable, controlled operation.

The PBP20N2R model includes a foldable platform for occasional ride-on use, while the PBP20N2E offers rising forks for easy loading and unloading.



PBP20N2R

Frame and Body

- **Sealed chassis** offers protection against dirt, dust and other particles to reduce wear.
- **Water-resistant design** diverts splashed moisture away from key electrical components, for long truck life.
- **High stability** is ensured by use of two linked castor wheels – next to the central drive wheel – in addition to the load wheels.
- **Low center of gravity** adds further stability, for safe operation.

Forks

- **Robust forks** with welded construction, and rounded tips for effortless pallet entry, give extra strength and durability.
- **Market-leading lift height** of 135 mm allows easy handling on steep ramps and loading docks, even with damaged pallets.
- **Rising forks** on PBP20N2E place loads at an ergonomic height – maximum 735 mm – for loading and unloading with minimal physical strain.



MARKET-LEADING LIFT HEIGHT



Drive

- **Powerful AC drive motor** is placed above the chassis plate, safeguarding it against the elements.
- **Oil-filled, sealed transmission** is shock-resistant, quiet and requires little maintenance.



AC DRIVE MOTOR

Steering System

- **State-of-the-art tiller arm** offers the ultimate in ergonomic design, comfort and safety.
- **Small turning circle** together with compact chassis and excellent visibility means exceptional manoeuvrability.



TILLER ARM

Electrical and Control Systems

- **Programmable controller** adjusts acceleration, travel speed and braking to suit the application and operator – for greater versatility.
- **On-board diagnostics** and fault memory folder speed up servicing and help prevent damage.
- **High-efficiency electronic system** features waterproof components for maximum reliability – even in moist conditions.
- **Versatile battery compartment** accommodates DIN and BS size batteries with a variety of capacities for maximum compatibility with user's equipment and needs.



VERSATILE BATTERY COMPARTMENT

Operator Environment & Controls

- **Creep speed function and tiller arm lock bypass** maximise safety and control in confined spaces.
- **Unique crossbar design** deflect obstacles away from tiller arm and operator's hand, protecting both truck and operator.
- **Choice of two performance modes** via key switch enhances safety, energy efficiency and productivity.
- **Easy-to-operate controls** reduce operator fatigue and minimise mistakes to enhance safety.
- **Ergonomically shaped rubber hand grips** are comfortable and slip-free, allowing for easy reach of controls.



- **Battery discharge indicator** is fitted as standard for battery protection and monitoring of truck use.
- **Ground clearance** is only 35 mm – which makes foot trapping very unlikely.
- **Spacious, suspended foldable platform** on PBP20N2R allows operator to ride in comfort – maximum speed 6 km/h – during occasional longer travel.



Options include:

- Choice of drive and load wheels for different applications
- Single load wheels (standard on PBP16N2)
- Sealed inbuilt battery charger (except PBP20N2R)
- Pallet entry and exit rollers
- Wide variety of fork dimensions
- Cold store modification (class III, -35°C)
- Load backrest
- Multifunctional display with hour meter
- Equipment bar for mounting accessories
- 375 Ah battery (PBP20N2 and PBP20N2R)
- Fingertip levers on tiller arm
- Rapid and/or double battery change device (PBP18N2 and PBP20N2)
- PIN code unit (PBP20N2R)
- LED Working light (PBP20N2R)

Other Features

- **RapidAccess feature** allows quick and easy entry to all areas for checks and maintenance.

SPECIFICATIONS

Characteristics						
1	Manufacturer (abbreviation)		Mitsubishi	Mitsubishi	Mitsubishi	Mitsubishi
2	Manufacturer's model designation		PBP16N2	PBP18N2	PBP20N2	PBP20N2R
3	Power source (battery, diesel, LP gas, petrol)		Battery	Battery	Battery	Battery
4	Operator type: pedestrian, (operator)-standing, -seated		Pedestrian	Pedestrian	Pedestrian	Pedestrian/Stand-on
5	Load capacity	Q (kg)	1600	1900	2000	2000
6	Load centre distance	c (mm)	600	600	600	600
7	Load wheel axle to fork face (forks lowered)	x (mm)	960	960	960	961
8	Wheelbase	y (mm)	1360	1424	1424	1433
Weight						
9	Truck weight with maximum battery weight	kg	431	502	634	595
10	Axle loadings with nominal load & maximum battery weight, drive/load side	kg	635 / 1396	806 / 1496	864 / 1770	890 / 1705
11	Axle loadings without load & maximum battery weight, drive/load side	kg	332 / 99	381 / 121	475 / 159	470 / 125
Wheels, Drive Train						
12	Tyres: PT=Power Thane, Vul=Vulkollan, drive/load side		Vul/Vul	Vul/Vul	Vul/Vul	Vul/Vul
13	Tyre dimensions, drive side	(mm)	230 x 70	230 x 70	85 x 75	85 x 75
14	Tyre dimensions, load side	(mm)	85 x 90	85 x 75	230 x 70	230 x 70
15	Castor wheel dimensions (diameter x width)	(mm)	100 x 40	100 x 40	100 x 40	125 x 55
16	Number of the wheels drive/load side (x=driven)		2+1x/2	2+1x/4	2+1x/4	2+1x/4
17	Track width (centre of tyres), drive side	b10 (mm)	480	480	480	480
18	Track width (centre of tyres), load side	b11 (mm)	355 / 375 / 495	355 / 375 / 495	355 / 375 / 495	375
Dimensions						
19	Lift height	h3 (mm)	135	135	135	510
20	Initial lift height	h5 (mm)	-	-	-	135
21	Seat- or stand height	h7 (mm)	-	-	-	172
22	Height of tiller arm / steering console (min/max)	h14 (mm)	1050 / 1372	1050 / 1372	1050 / 1372	1180 / 1350
23	Fork height, fully lowered	h13 (mm)	85	85	85	90
24	Overall length, platform up/down	/1 (mm)	1648	1712	1712	1852 / 2346
25	Length to fork face, platform up/down	/2 (mm)	498	562	562	702 / 1195
26	Overall width	b1/b2 (mm)	720	720	720	720
27	Fork dimensions (thickness, width, length)	s/e/l (mm)	55 / 165 / 1150	55 / 165 / 1150	55 / 165 / 1150	50 / 165 / 1150
28	Outside width over forks	b5 (mm)	520 / 540 / 660	520 / 540 / 660	520 / 540 / 660	540
29	Ground clearance, center of wheelbase (forks lowered)	m2 (mm)	30	30	30	30
30	Working aisle width (Ast) with 1000 x 1200 mm pallet, load crosswise, platform up/down	Ast (mm)	1694	1758	1758	1920 / 2400
31	Working aisle width (Ast) with 800 x 1200 mm pallet, load lengthwise, platform up/down	Ast (mm)	1894	1958	1958	2120 / 2600
32	Turning circle radius	Wa (mm)	1454	1518	1518	1680 / 2160
Performance						
33	Travel speed, with/without load	km/h	6.0 / 6.0	6.0 / 6.0	6.0 / 6.0	6.0 / 6.0
34	Lifting speed, with/without load	m/s	0.035 / 0.045	0.035 / 0.045	0.04 / 0.06	0.03 / 0.05
35	Lowering speed, with/without load	m/s	0.05 / 0.05	0.05 / 0.05	0.05 / 0.05	0.07 / 0.08
36	Gradeability, with/without load	%	10.0 / 20.0	10.0 / 20.0	10.0 / 20.0	9.0 / 20.0
37	Service brakes (mechanical/hydraulic/electric/pneumatic)		Electric	Electric	Electric	Electric
Electric motors						
38	Drive motor capacity (60 min. short duty)	kW	1.0	1.0	1.0	1.0
39	Lift motor output at 15% duty factor	kW	0.8	0.8	1.2	1.2
40	Battery voltage/capacity at 5-hour discharge	V/Ah	24 / 150	24 / 250	24 / 250-375*	24 / 250-375*
41	Battery weight	kg	151	212	212-294	212-294
Miscellaneous						
42	Type of drive control		Stepless	Stepless	Stepless	Stepless
43**	Noise level, mean value at operator's ear (EN 12 053), drive/lift/idle	dB (A)	62 / 69 / 0	62 / 69 / 0	65 / 67 / 0	63 / 78 / 0
	Whold-body vibration (EN 13 059)	m/s ²	-	-	-	0.9
	Hand-arm vibration (EN 13 059)		< 2.5	< 2.5	< 2.5	< 2.5

* with 375Ah battery l2 dimension increases 72 mm

** Margin of error +/- 4 dB(A) in section 43

PBP16/18/20N2

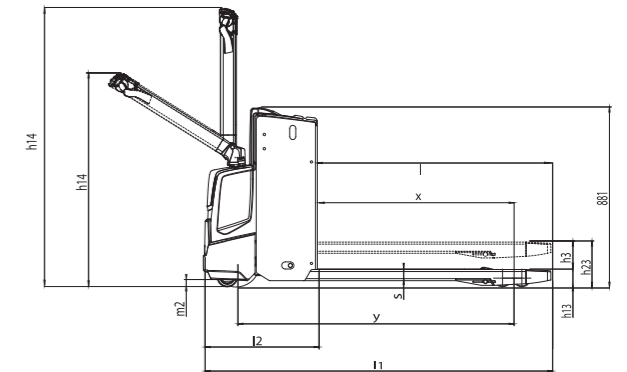
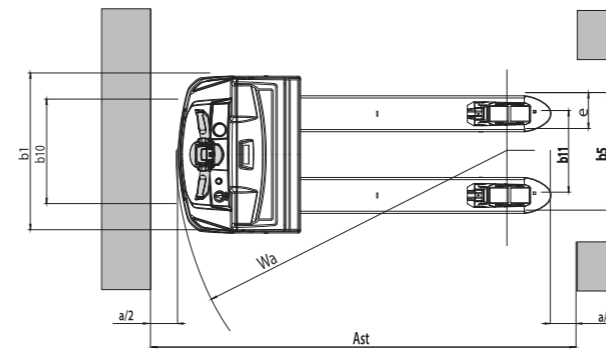

PBP20N2R: with folding platform

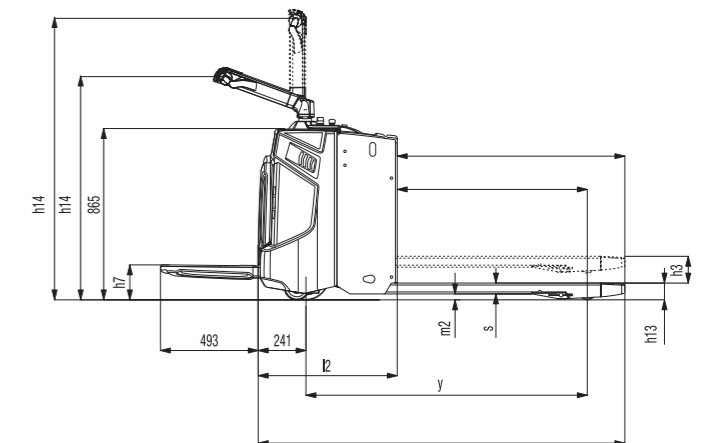
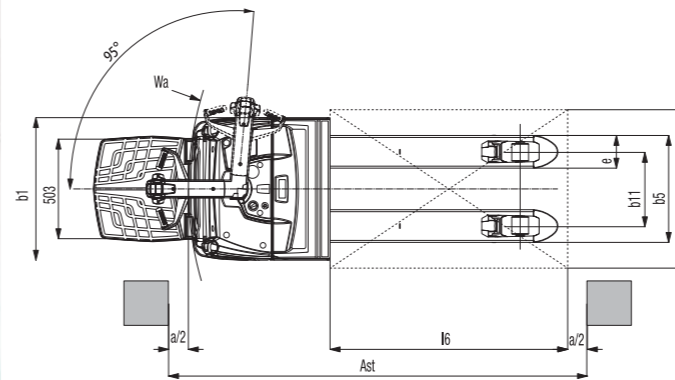

PBP20N2E: with rising forks

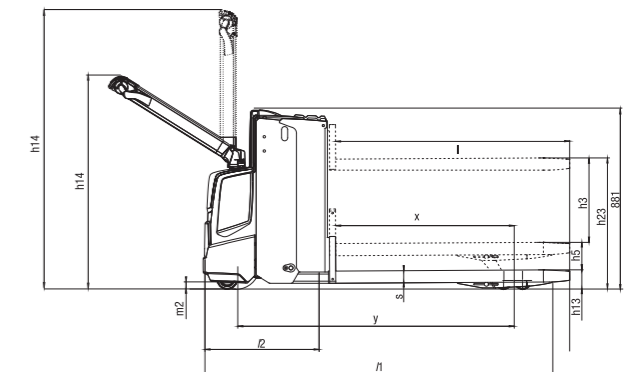
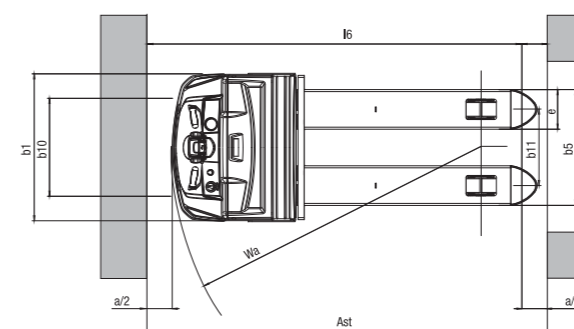

Ast = Wa-x+l6+a
a = Safety clearance (200 mm)
l6 = Pallet length